

BGX & BGC シリーズ規格寸法表 (S-B)

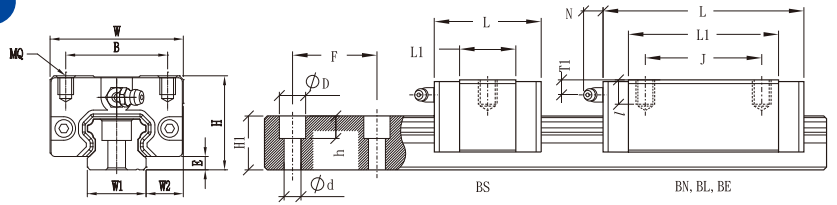

型番	組立寸法 - mm				ブロック寸法 - mm								レール寸法 - mm						基本定格荷重 - kN				静定格モーメント kNm			ブロック重量 kg	レール重量 kg/m	
	H	W	W2	E	L	B	J	MQ	I	L1	Oil H	T1	N	W1	H1	F	d	D	h	C-BGX	C-BGC	CO-BGX	CO-BGC	M _x	M _y			M _z
S15BS	24	34	9.5	3.4	40.6	26		M4	4.8	22.2	M4X0.7	5.5	(5.7)	15	13.0	60	4.5	7.5	5.5	6.9	5.7	10.8	9.8	0.068	0.032	0.032	0.10	1.28
S15BN	24	34	9.5	3.4	58.6	26	26	M4	4.8	40.2	M4X0.7	5.5	(5.7)	15	13.0	60	4.5	7.5	5.5	13.0	11.5	21.6	19.6	0.136	0.117	0.117	0.17	1.28
S15BL	24	34	9.5	3.4	66.1	26	26	M4	4.8	47.7	M4X0.7	5.5	(5.7)	15	13.0	60	4.5	7.5	5.5	14.1	13.9	26.1	23.7	0.164	0.169	0.169	0.18	1.28
S20BS	28	42	11.0	4.5	49.1	32		M5	5.5	27.5	M6X1.0	5.1	(12.3)	20	16.3	60	6.0	9.5	8.5	11.1	9.1	17.3	15.7	0.146	0.064	0.064	0.17	2.15
S20BN	28	42	11.0	4.5	70.1	32	32	M5	5.5	48.5	M6X1.0	5.1	(12.3)	20	16.3	60	6.0	9.5	8.5	21.5	17.7	33.6	30.5	0.285	0.220	0.220	0.26	2.15
S25BS	33	48	12.5	5.8	54.0	35		M6	6.8	32.3	M6X1.0	7.2	(12.2)	23	19.2	60	7.0	11.0	9.0	15.5	12.7	23.1	21	0.225	0.101	0.101	0.21	2.88
S25BN	33	48	12.5	5.8	79.2	35	35	M6	6.8	57.5	M6X1.0	7.2	(12.2)	23	19.2	60	7.0	11.0	9.0	28.1	24.8	45.2	41.1	0.440	0.352	0.352	0.38	2.88
X25BN	36	48	12.5	5.8	79.2	35	35	M6	9.0	57.5	M6X1.0	10.2	(12.2)	23	19.2	60	7.0	11.0	9.0	28.1	24.8	45.2	41.1	0.440	0.352	0.352	0.40	2.88
X25BL	36	48	12.5	5.8	93.9	35	35	M6	9.0	72.2	M6X1.0	10.2	(12.2)	23	19.2	60	7.0	11.0	9.0	33.7	31.9	58.1	52.8	0.566	0.568	0.568	0.54	2.88
X25BE	36	48	12.5	5.8	108.6	35	50	M6	9.0	86.9	M6X1.0	10.2	(12.2)	23	19.2	60	7.0	11.0	9.0	38.0	36.0	69.6	63.3	0.679	0.819	0.819	0.67	2.88
S30BS	42	60	16.0	7.0	64.2	40		M8	10.0	37.2	M6X1.0	10	(11.7)	28	22.8	80	9.0	14.0	12.0	22.1	18.2	29.7	27	0.350	0.150	0.150	0.50	4.45
S30BN	42	60	16.0	7.0	94.8	40	40	M8	10.0	67.8	M6X1.0	10	(11.7)	28	22.8	80	9.0	14.0	12.0	41.6	36.7	60.1	54.6	0.706	0.551	0.551	0.80	4.45
S30BL	42	60	16.0	7.0	105.0	40	40	M8	10.0	78.0	M6X1.0	10	(11.7)	28	22.8	80	9.0	14.0	12.0	48.1	47.5	77.8	70.7	0.915	0.821	0.821	0.94	4.45
S30BE	42	60	16.0	7.0	130.5	40	60	M8	10.0	103.5	M6X1.0	10	(11.7)	28	22.8	80	9.0	14.0	12.0	57.9	52.9	95.4	86.7	1.122	1.336	1.336	1.16	4.45
S35BS	48	70	18.0	7.5	75.5	50		M8	10.0	44.5	M6X1.0	11.5	(11.5)	34	26.0	80	9.0	14.0	12.0	31.8	26.2	44.8	40.7	0.643	0.269	0.269	0.80	6.25
S35BN	48	70	18.0	7.5	111.5	50	50	M8	10.0	80.5	M6X1.0	11.5	(11.5)	34	26.0	80	9.0	14.0	12.0	59.4	52.3	89.2	81.1	1.282	0.972	0.972	1.20	6.25
S35BL	48	70	18.0	7.5	123.5	50	50	M8	10.0	92.5	M6X1.0	11.5	(11.5)	34	26.0	80	9.0	14.0	12.0	68.8	65.4	111.5	101.4	1.602	1.396	1.396	1.40	6.25
S35BE	48	70	18.0	7.5	153.5	50	72	M8	10.0	122.5	M6X1.0	11.5	(11.5)	34	26.0	80	9.0	14.0	12.0	81.6	71.9	137.8	125.3	1.981	2.286	2.286	1.84	6.25
S45BN	60	86	20.5	8.9	129.0	60	60	M10	15.5	94.0	M8X1.25	14.4	(10.8)	45	31.1	105	14.0	20.0	17.0	81.2	71.6	119.8	108.9	2.300	1.524	1.524	1.64	9.60
S45BL	60	86	20.5	8.9	145.0	60	60	M10	15.5	110.0	M8X1.25	14.4	(10.8)	45	31.1	105	14.0	20.0	17.0	89.7	85.1	142.5	129.5	2.736	2.122	2.122	1.93	9.60
S45BE	60	86	20.5	8.9	174.0	60	80	M10	15.5	139.0	M8X1.25	14.4	(10.8)	45	31.1	105	14.0	20.0	17.0	103.6	98.4	179.6	163.3	3.449	3.379	3.379	2.42	9.60
S55BN	70	100	23.5	12.7	155.0	75	75	M12	18.0	116.0	M8X1.25	14.0	(10.8)	53	38.0	120	16.0	23.0	20.0	104.7	86.2	146.7	133.4	3.303	2.304	2.304	2.67	13.80
S55BL	70	100	23.5	12.7	193.0	75	75	M12	18.0	154.0	M8X1.25	14.0	(10.8)	53	38.0	120	16.0	23.0	20.0	131.9	116.3	196.8	178.9	4.428	4.101	4.101	3.57	13.80
S55BE	70	100	23.5	12.7	210.0	75	95	M12	18.0	171.0	M8X1.25	14.0	(10.8)	53	38.0	120	16.0	23.0	20.0	166.0	157.7	279.0	253.6	6.279	6.458	6.458	3.97	13.80

BGX & BGC シリーズ規格寸法表 (H-F) (S-F)

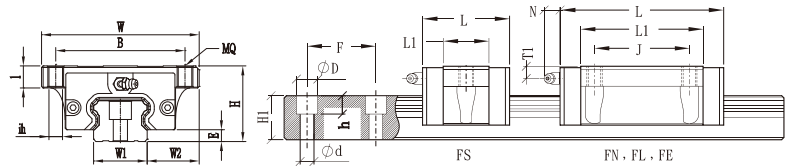

型番	組立寸法 - mm				ブロック寸法 - mm								レール寸法 - mm						基本定格荷重 - kN				静定格モーメント kNm			ブロック重量 kg	レール重量 kg/m		
	H	W	W2	E	L	B	J	MQ	ih	I	L1	Oil H	T1	N	W1	H1	F	d	D	h	C-BGX	C-BGC	CO-BGX	CO-BGC	M _x			M _y	M _z
H15FN	24	47	16.0	3.4	58.6	38	30	M5	4.4	7.5	40.2	M4X0.7	5.5	(5.7)	15	13.0	60	4.5	7.5	5.5	13.0	11.5	21.6	19.6	0.136	0.117	0.117	0.21	1.28
H15FL	24	47	16.0	3.4	66.1	38	30	M5	4.4	7.5	47.7	M4X0.7	5.5	(5.7)	15	13.0	60	4.5	7.5	5.5	14.1	13.9	26.1	23.7	0.164	0.169	0.169	0.23	1.28
S15FS	24	52	18.5	3.4	40.6	41		M5	4.4	7.5	22.2	M4X0.7	5.5	(5.7)	15	13.0	60	4.5	7.5	5.5	6.9	5.7	10.8	9.8	0.068	0.032	0.032	0.12	1.28
S15FN	24	52	18.5	3.4	58.6	41	26	M5	4.4	7.5	40.2	M4X0.7	5.5	(5.7)	15	13.0	60	4.5	7.5	5.5	13.0	11.5	21.6	19.6	0.136	0.117	0.117	0.19	1.28
H20FN	30	63	21.5	4.5	70.1	53	40	M6	5.4	9.0	48.5	M6X1	7.1	(12.3)	20	16.3	60	6.0	9.5	8.5	21.5	17.7	33.6	30.5	0.285	0.220	0.220	0.40	2.15
H20FL	30	63	21.5	4.5	82.9	53	40	M6	5.4	9.0	61.3	M6X1	7.1	(12.3)	20	16.3	60	6.0	9.5	8.5	26.0	23.0	43.5	39.5	0.369	0.361	0.361	0.46	2.15
H20FE	30	63	21.5	4.5	98.1	53	40	M6	5.4	9.0	76.5	M6X1	7.1	(12.3)	20	16.3	60	6.0	9.5	8.5	30.9	27.3	53.8	48.9	0.456	0.557	0.557	0.61	2.15
S20FS	28	59	19.5	4.5	49.1	49		M6	5.4	7.0	27.5	M6X1	5.1	(12.3)	20	16.3	60	6.0	9.5	8.5	11.1	9.1	17.3	15.7	0.225	0.101	0.101	0.18	2.15
S20FN	28	59	19.5	4.5	70.1	49	32	M6	5.4	7.0	48.5	M6X1	5.1	(12.3)	20	16.3	60	6.0	9.5	8.5	21.5	17.7	33.6	30.5	0.285	0.220	0.220	0.31	2.15
H25FN	36	70	23.5	5.8	79.2	57	45	M8	6.8	10.1	57.5	M6X1	10.2	(12.2)	23	19.2	60	7.0	11.0	9.0	28.1	24.8	45.2	41.1	0.440	0.352	0.352	0.57	2.88
H25FL	36	70	23.5	5.8	93.9	57	45	M8	6.8	10.1	72.2	M6X1	10.2	(12.2)	23	19.2	60	7.0	11.0	9.0	33.7	31.9	58.1	52.8	0.566	0.568	0.568	0.72	2.88
H25FE	36	70	23.5	5.8	108.6	57	45	M8	6.8	10.1	86.9	M6X1	10.2	(12.2)	23	19.2	60	7.0	11.0	9.0	38.0	36.0	69.6	63.3	0.679	0.819	0.819	0.89	2.88
S25FS	33	73	25.0	5.8	54.0	60		M8	6.8	7.1	32.3	M6X1	7.2	(12.3)	23	19.2	60	7.0	11.0	9.0	15.5	12.7	23.1	21.0	0.225	0.101	0.101	0.33	2.88
S25FN	33	73	25.0	5.8	79.2	60	35	M8	6.8	7.1	57.5	M6X1	7.2	(12.3)	23	19.2	60	7.0	11.0	9.0	28.1	24.8	45.2	41.1	0.440	0.352	0.352	0.50	2.88
H30FS	42	90	31.0	7.0	64.2	72		M10	8.6	12.0	37.2	M6X1	10	(11.7)	28	22.8	80	9.0	14.0	12.0	22.1	18.2	29.7	27.0	0.350	0.150	0.150	0.80	4.45
H30FN	42	90	31.0	7.0	94.8	72	52	M10	8.6	12.0	67.8	M6X1	10	(11.7)	28	22.8	80	9.0	14.0	12.0	41.6	36.7	60.1	54.6	0.706	0.551	0.551	1.10	4.45
H30FL	42	90	31.0	7.0	105.0	72	52	M10	8.6	12.0	78.0	M6X1	10	(11.7)	28	22.8	80	9.0	14.0	12.0	48.1	47.5	77.8	70.7	0.915	0.821	0.821	1.34	4.45
H30FE	42	90	31.0	7.0	130.5	72	52	M10	8.6	12.0	103.5	M6X1	10	(11.7)	28	22.8	80	9.0	14.0	12.0	57.9	52.9	95.4	86.7	1.122	1.336	1.336	1.66	4.45
H35FS	48	100	33.0	7.5	75.5	82		M10	8.6	14.0	44.5	M6X1	11.5	(11.5)	34	26.0	80	9.0	14.0	12.0	31.8	26.2	44.8	40.7	0.643	0.269	0.269	1.00	6.25
H35FN	48	100	33.0	7.5	111.5	82	62	M10	8.6	14.0	80.5	M6X1	11.5	(11.5)	34	26.0	80	9.0	14.0	12.0	59.4	52.3	89.2	81.1	1.282	0.972	0.972	1.50	6.25
H35FL	48	100	33.0	7.5	123.5	82	62	M10	8.6	14.0	92.5	M6X1	11.5	(11.5)	34	26.0	80	9.0	14.0	12.0	68.8								